

Nowadays, many parks in Shanghai are well maintained, but they also expose many problems, such as: the user's age structure is single, the park is not functional and lacks connectivity with the surrounding. This paper is aimed at the design of Yanchun Park in Yangpu District, Shanghai. It aims to revitalize the park through the design of the landscape and make it available to more people.

The result of the design is a combination of subjective and objective. Under the premise of solving the objective problem, some subjective design forms and techniques are added to complete the final design. Not only do I have to solve the problems exposed by the current park, but also inject new vitality into it, and at the same time have certain requirements in aesthetics.

Finally, this is a community park in Shanghai, which is also a typical case. There are many similar parks in Shanghai that have the same problem. Perhaps the design of this paper can also provide a design possibility for other parks with similar situations. Revitalize community parks such as Yanchun Park.

This article through the design of the park, the first is to solve the problems exposed by the current park. Under the premise of conforming to China's national conditions, try to make a better combination of form and function. Secondly, people are always the core of design considerations. If a landscape design ignores people's needs, then this design is also doomed to failure. For Yanchun Park, it will be mentioned in the following papers that it pays more attention to the visual beauty and neglects the importance of function. How to combine the user's behavior and psychological factors with the function is the second question that needs to be considered in this paper.

The first meaning of this paper is to provide a design plan for Yanchun Park, in which many existing problems can be solved. Secondly, in Shanghai alone, there are dozens of community parks such as Yanchun Park, and they all face the problem of becoming an "old man park". This paper hopes to provide a plan for other community parks with similar problems through the design of Yanchun Park, which can provide a reference for other parks that need to be designed. Finally, there are many design projects in China, but there is not much attention to the "growth" of a design. Currently, the design tends to focus only on the current and ignores the development after 10 years, 20 years, or even longer. How to keep up with the times, whether this paper can be used to cause all the attention to the development of the park is the third meaning of this article.

Analysis

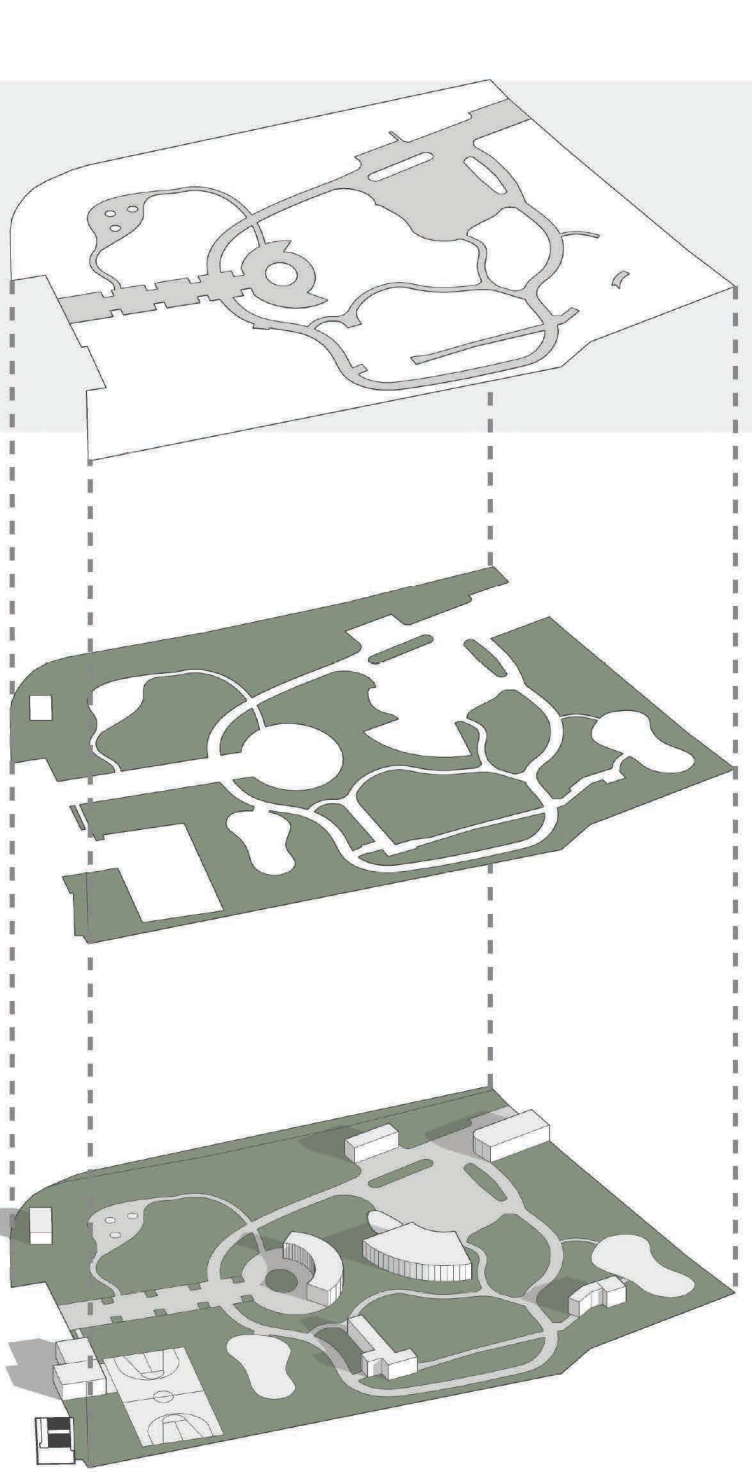
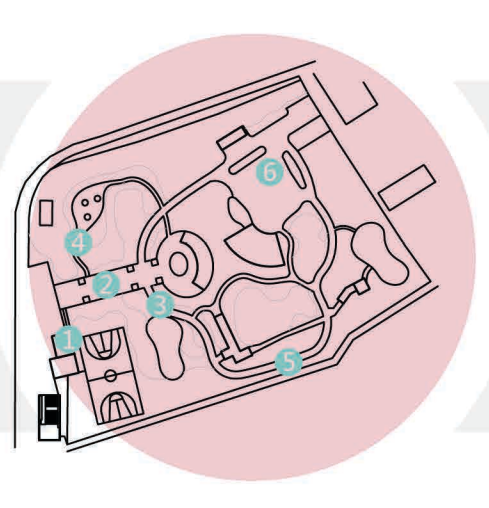
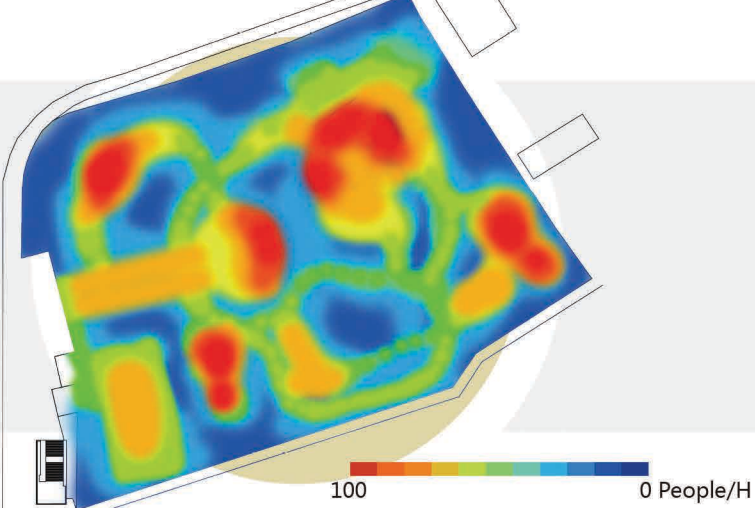
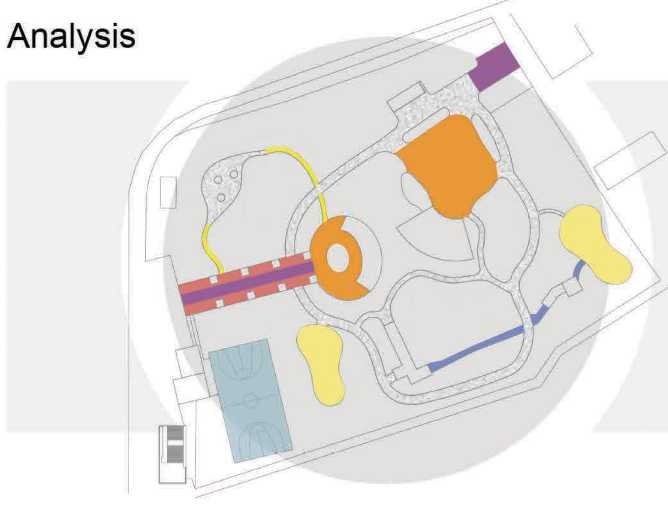

MATERIALS

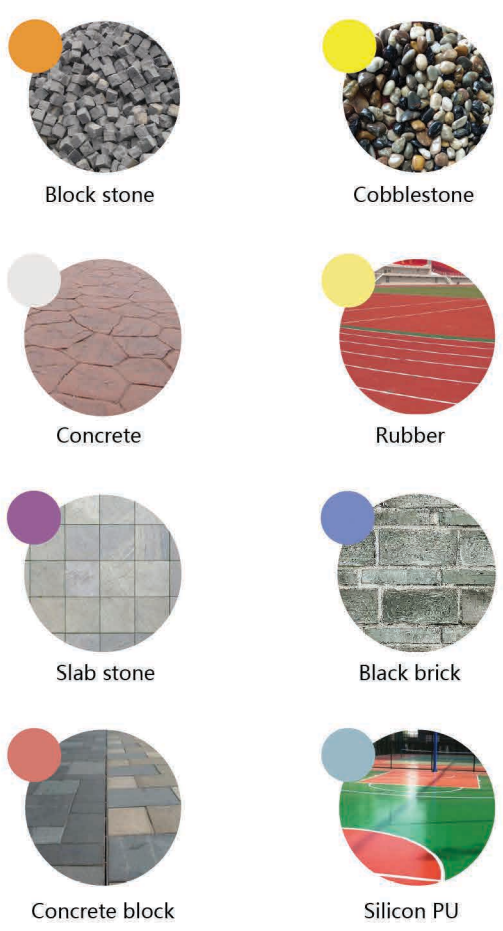

USERS

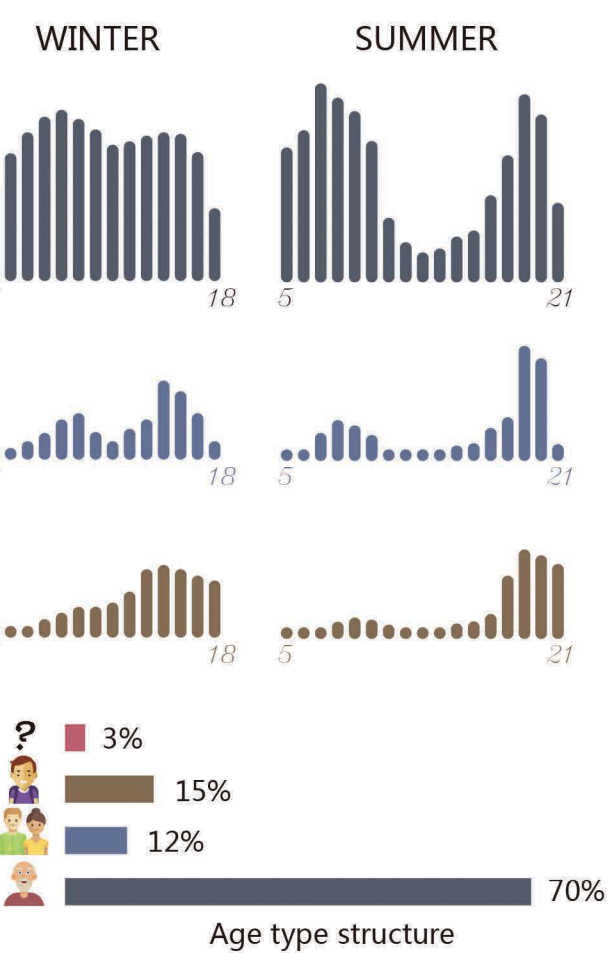

FEELINGS

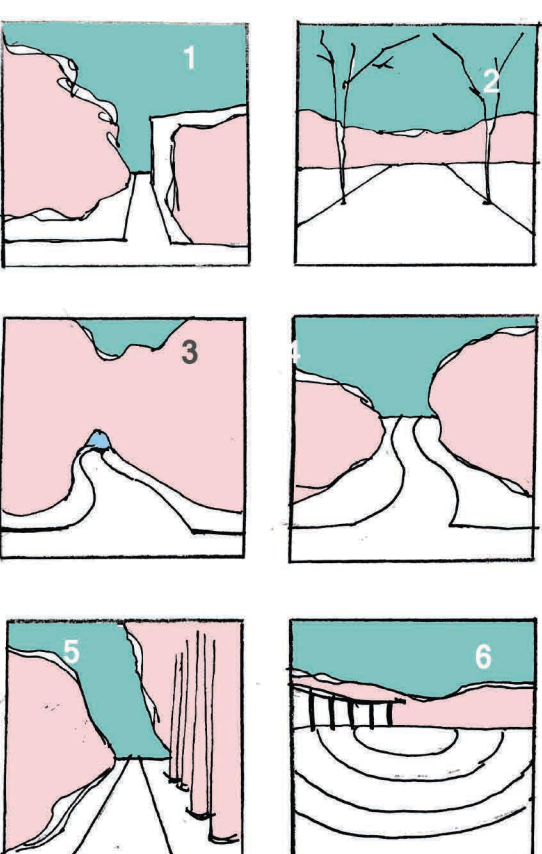

- I CENTER LOOP
- II MAIN SQUARE & ENTRANCE
- III SECOND ENTRANCE
- IV THIRD ENTRANCE
- V BASKETBALL COURT
- VI PLAYGROUND
- VII COURTYARD
- VIII DANCING SQUARE
- IX BIKE PARKING I
- X BIKE PARKING II

LOGO

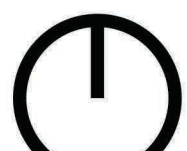

MASTER PLAN

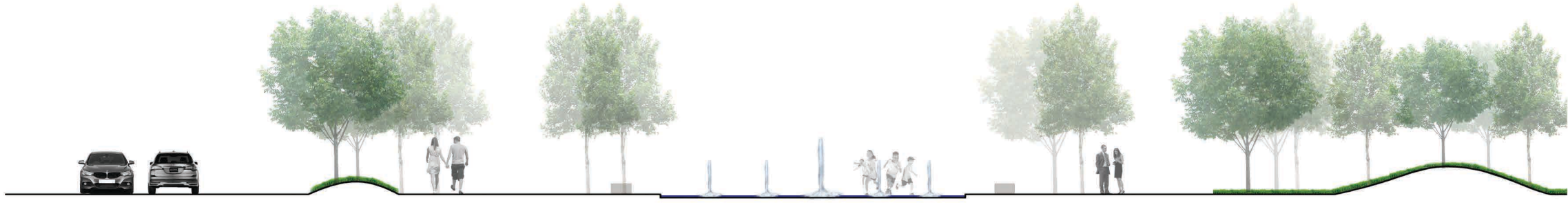
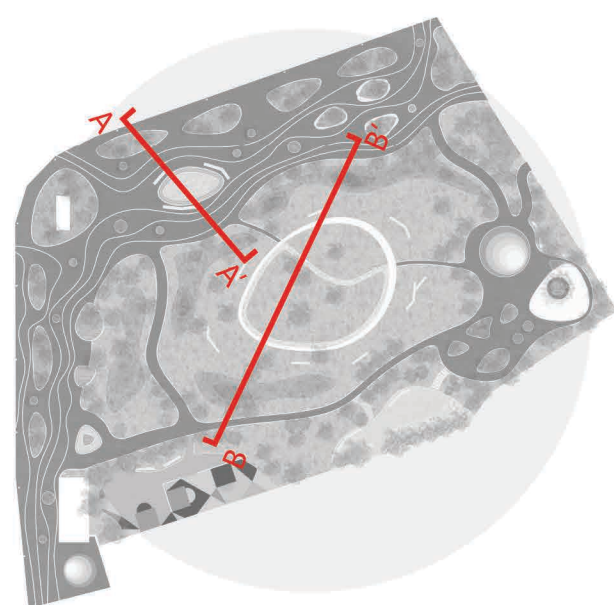

Section A-A'



Section B-B'

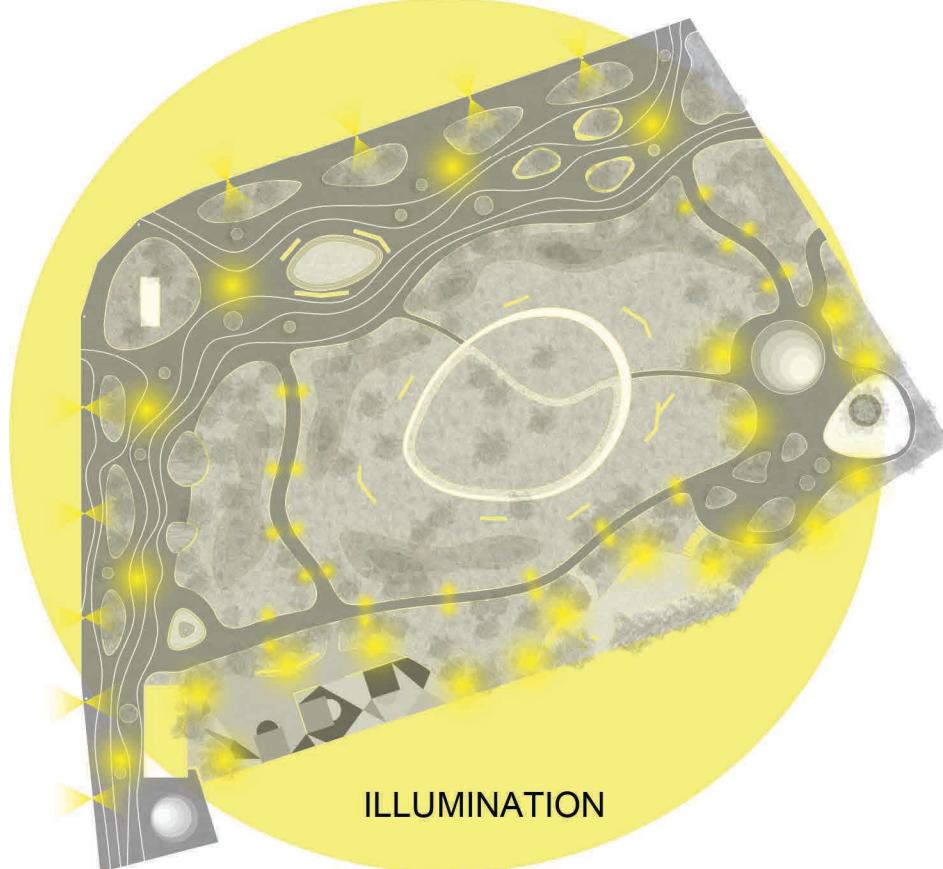

ILLUMINATION

