

m l a 2014-2016

portfolio

IVAN JUAREZ

ivan @ x - studio . tv

MLA. MASTER IN LANDSCAPE ARCHITECTURE

SZENT ISTVÁN UNIVERSITY

FACULTY OF LANDSCAPE ARCHITECTURE AND URBAN PLANNING

| 00 |



diploma work m.l.a.

sensory trails

normafa . budapest

The diploma thesis focuses on the development of new approaches to the natural and cultural landscape of Normafa, a protected forest located in the XIIth District of Budapest which functions also as a public park for the residents of Hungary's capital.

The project proposes the conceptualization and design of a series of sensory trails and site-specific interventions that create new dialogues to perceive the landscape through senses and perceptions.

The project is proposed as an instrument that utilizes senses as a method of approximation to the site by increasing the perceptions to the landscape through the connection of nature with multi-sensory experiences: scents, textures, sounds, tastes and scenes.

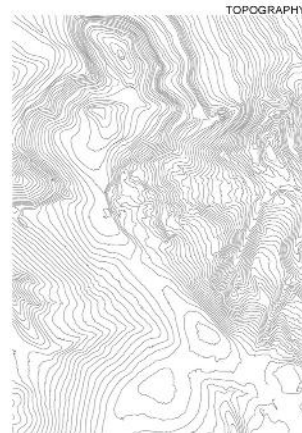
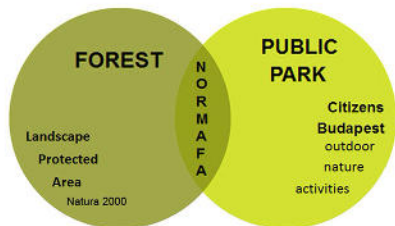

The design has been developed through the following conceptual strategies: The conductive thread, designed as a linking element that travels across the different landscapes of Normafa, drawing a new reading of the site. The multi-purpose sensory devices, designed as the key approaching elements that emerge from the conductive thread, emphasize specific perceptual points along the route and create new dialogues between the visitor and the surrounding landscape. The design of the network system, links the different landscape characters of Normafa and integrates its existing path network. The linking gates are conceived as landmarks that connect the five sensory trails and provide information about the trails; and the last conceptual strategy: the mostly-level trails, designed according to criteria of human movement, making the walk feasible for visitors, running nearly in the same elevation level.



SENSES

SPECIES + NATURAL & CULTURAL FEATURES

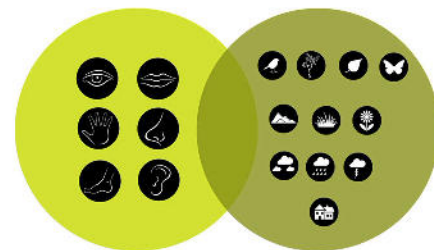
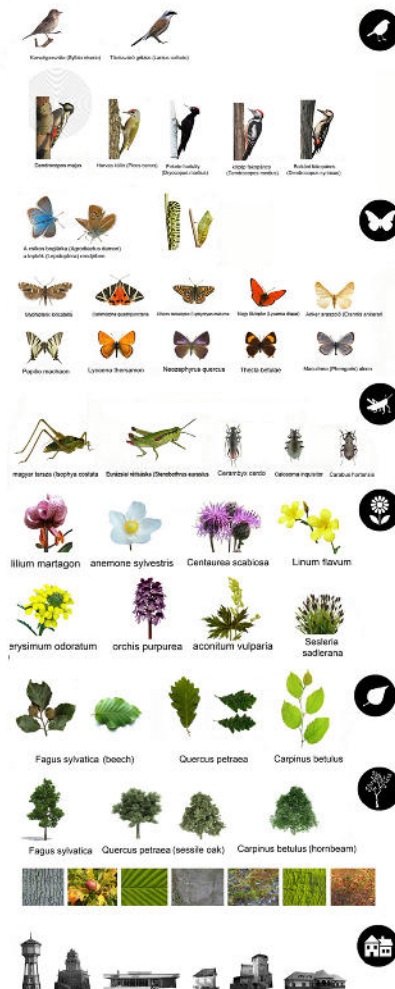

SENSES + NATURAL & CULTURAL FEATURES



tactile experiences

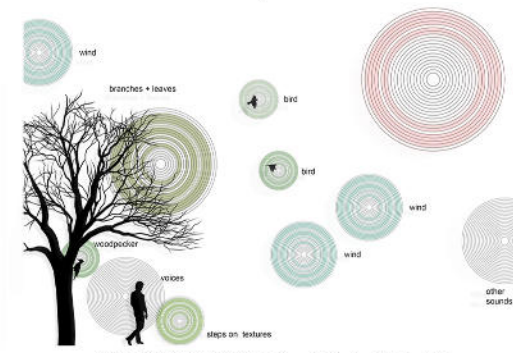

identification of sounds

sensory trails

normafa . budapest

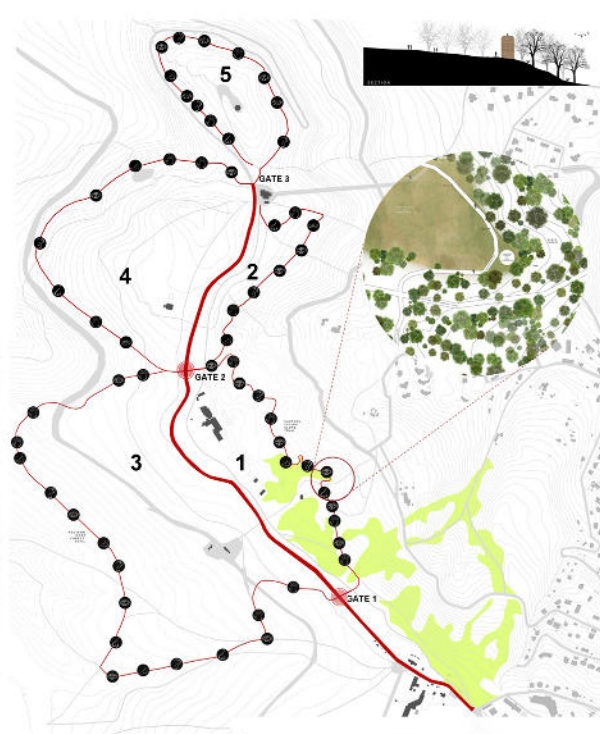

NETWORK SYSTEM CONCEPT

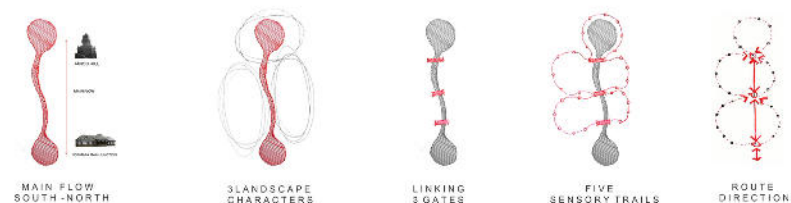

GATE



BIRD WATCHING



LANDSCAPE FRAME

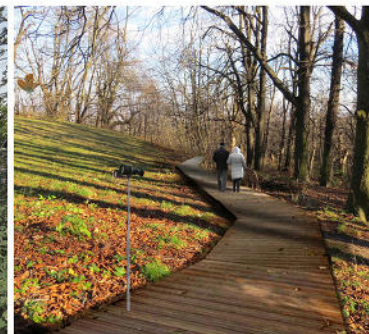

PATH MEADOWS+STEEP FOREST



SCENERY PLATFORM



TOUCHING BARKS

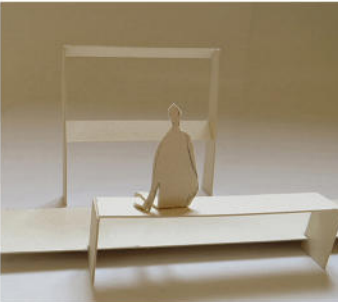
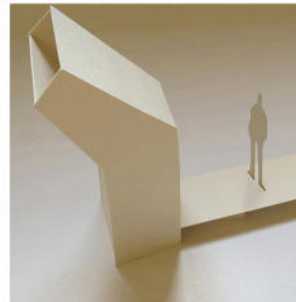
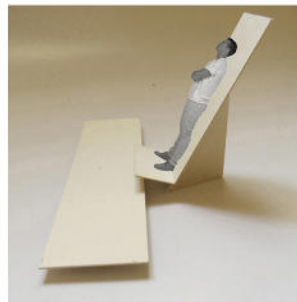
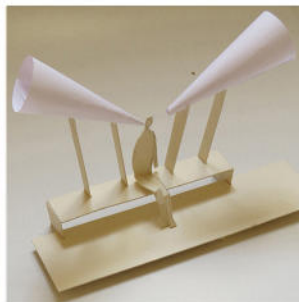
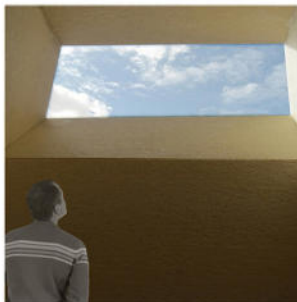
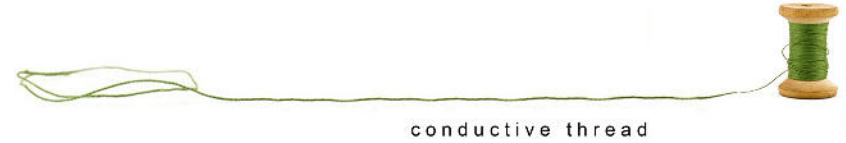
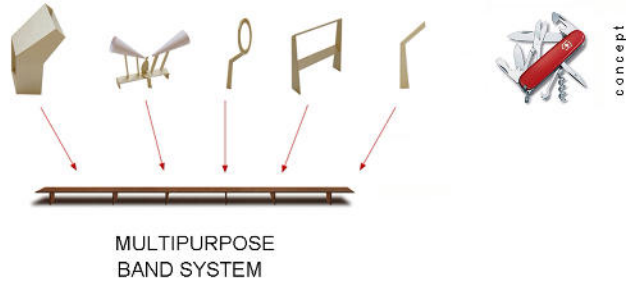

mla 2014-2016

PROCESS + PROJECTS + STRATEGIES

design process:	freehand drawings	01
historic landscapes:	gödöllő, hungary ludovika project	02
regional planning:	3 villages, strategies	03
public park:	germanus gyula park	04
planting design:	danube river bank	05
green infrastructure:	improving biodiversity rakos creek collecting stormwater	06
open space design:	buda campus entrance	07
competitions:	design: drawing the limits memorial, water poems	08
graphics:	sketching modeling	09
complementary activities		10



01 design process

freehand drawing : plans + analysis + sketching

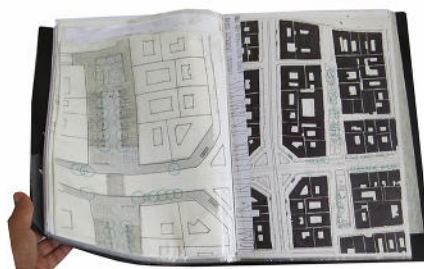
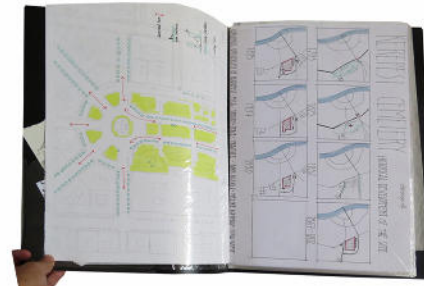
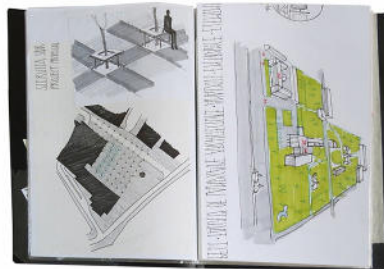

GÖDÖLLŐ HUNGARY

Gödöllő is also home to the historical Royal Palace and to the Szent István University, the main education institute of agriculture in Hungary.

The main goal and strategies of the project is the iintegration between the territory, the historical and natural landscape and the community creating a Continuous Urban, Natural and Cultural Landscape (CUNCL)

MAIN STRATEGIES

- Restoring Ecosystem: environmental recovery and treatment of the stream
- Evocation of the two historical water features designed with environmental contemporary goals
- Improvement and linking of the Historical layers + natural habitats + urban agriculture + outdoor spaces + ecological corridors + cultural routes.

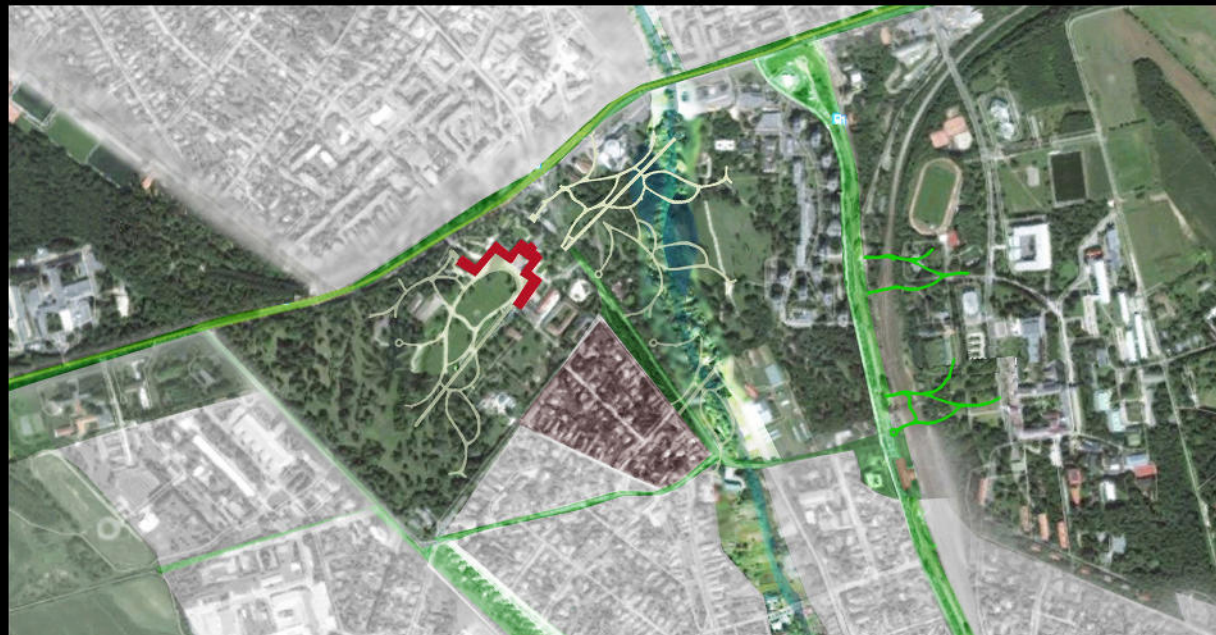

Gödöllo, main strategies



green ways Szabadság utca as a linear park, circulation route, pedestrians and bikes
Connection Erzsébet park and Upper Garden + SECESSION HISTORICAL ROUTE



historical alley : roval garden + lower park



recovering ecosystem: stream



Historic Landscapes

Historical Garden + The National University of Public Service

LUDOVIKA PROJECT

The National University of Public Service

started its operation as educational institute of the Hungarian public service on 2012.

The Ludovika Project proposes:

the 150 years old Ludovika building will be renovated to its original condition; 21st century infrastructure and equipment will be installed; the surrounding green park will be increased and supplemented with new buildings, including a shooting range, a riding course, new sports fields and a swimming pool.

The overall site of constructions will be 73,700 m², including 51,000 m² of new constructions. In addition, the renewal and enlargement of Orczi Park's 26 acres. The project proposes the conservation of the historical value of the site integrating Ludovika Square and Orczi Garden

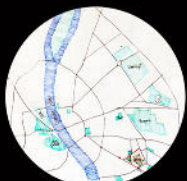

site location. Budapest



Ludovika square. main access



site present situation

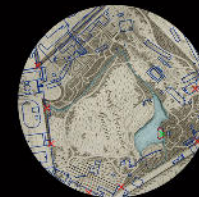

1810 historical map

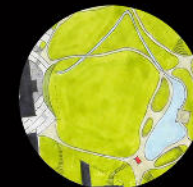

lake and clearing Orczi garden



blue + green network



concept

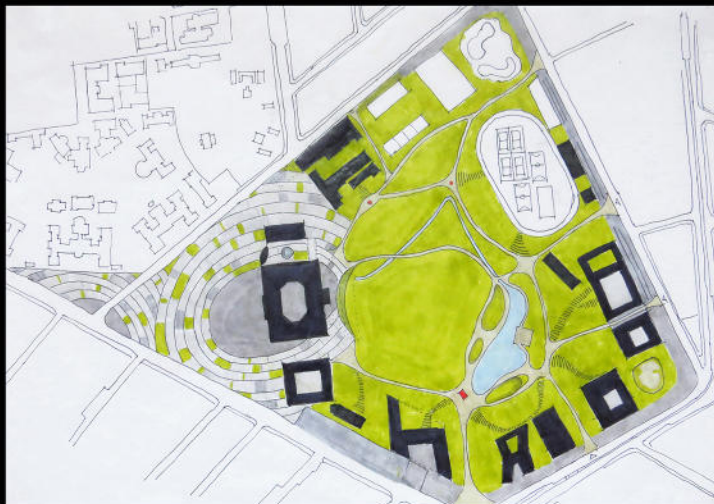

plan: project proposal



visualization: historical garden and the lake



visualization: Historical garden

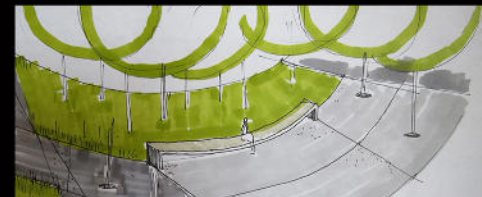

visualization: exterior new campus building



REGIONAL SUSTAINABLE STRATEGIES

VILLAGES:
DIÓSJENŐ+NOGRAD+BERKENYE
HUNGARY



General Map of the 3 villages

DIÓSJENŐ



Farm & wine cellar



Road



Train & housing



ENVIRONNEMENT // Communication process

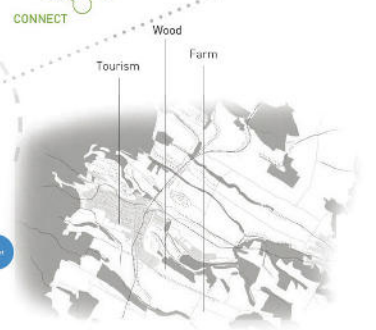
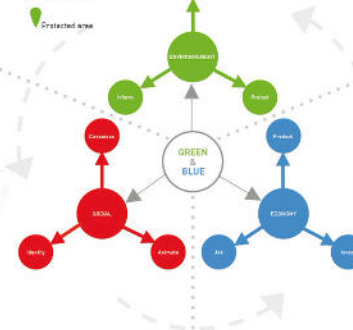
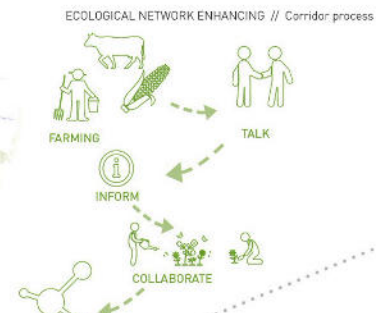
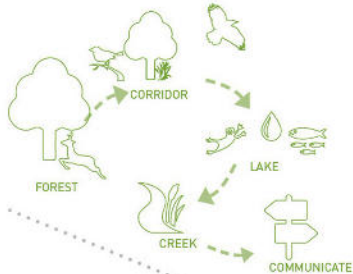

- Public space
- Community garden
- Paths
- Cellars
- Workshop



PARTICIPATORY PROCESS

Rehabilitation of community spaces // Building participatory process



LOCAL ECONOMY



COMMUNITY VILLAGE HOSTEL // Economy participatory process

A reflection space that moves the public and connects them to nature, the built landscape and each other.

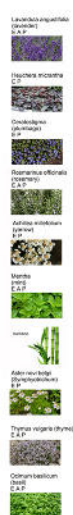

PLAN DETAIL

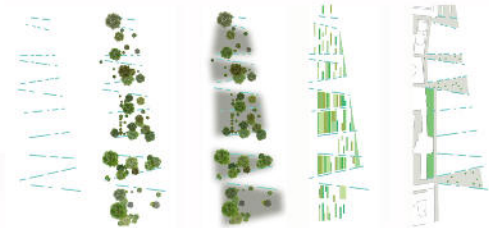

CONCEPTUALIZATION LAYERS, PERCEPTIONS AND EXPERIENCES



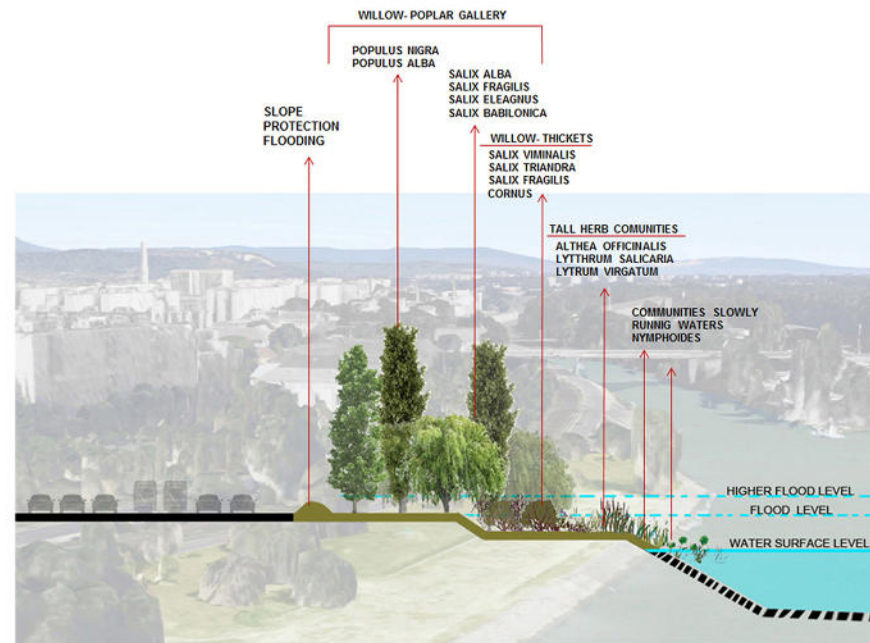
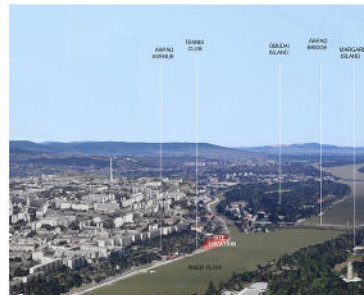



URBAN BIODIVERSITY
IMPROVEMENT
XI DISTRICT BUDAPEST

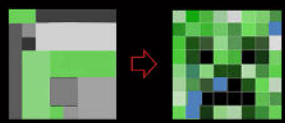

concept improvement

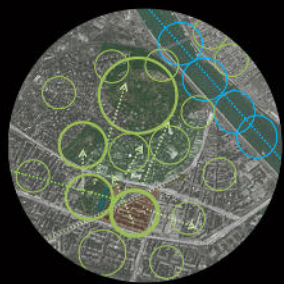

NEIGHBORHOOD LEVEL



STRATEGIES:
improvement
main roads as
green corridors



Improve biodiversity
species and
biodiversity
communication
strategies
in urban squares



Link the
park and
water features

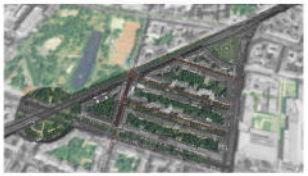

control
the vehicular traffic
into green ways



Improve biodiversity
and neighborhood
strategies in
courtyards



biodiversity
building
improvement.
Plantings on
balconies and
window boxes

URBAN BIODIVERSITY STRATEGIES



Plant use for higher sufficiency
and biodiversity



Permeable pavements

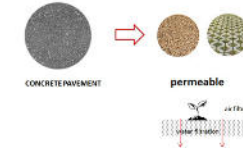

URBAN TOLERANT SPECIES (pollution tolerance)
flowering + fragrant shrubs



Link courtyards
and pedestrian streets

Green ways

Improve
Biodiversity
Front gardens

improve
Biodiversity
Front gardens

Improve
Biodiversity in Green courtyards
strategies

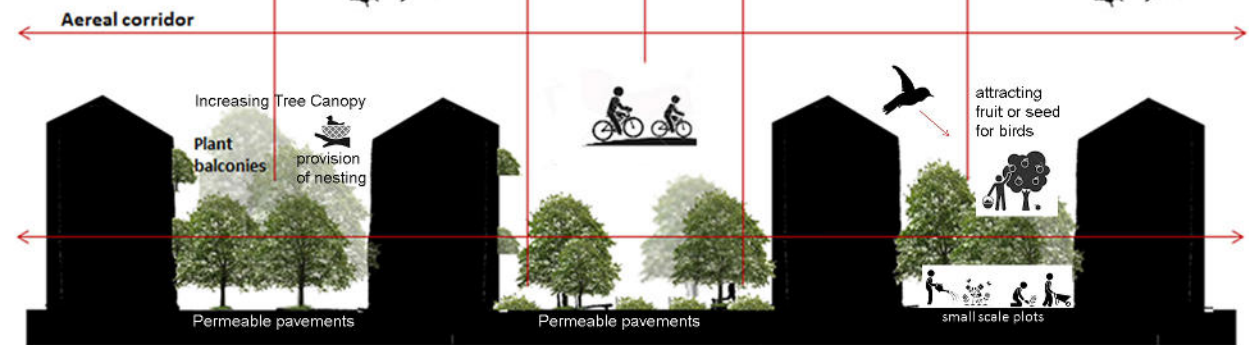

06
GREEN INFRASTRUCTURE
RAKOS CREEK
 CREEK SECTION : XIV DISTRICT . BUDAPEST



HUNGARY BLUE SYSTEM



BUDAPEST + DANUBE RIVER



DANUBE RIVER + RAKOS CREEK



1775 . MILITARY MAP

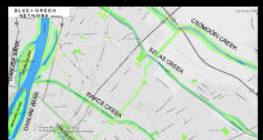

PEST. BLUE + GREEN NETWORK

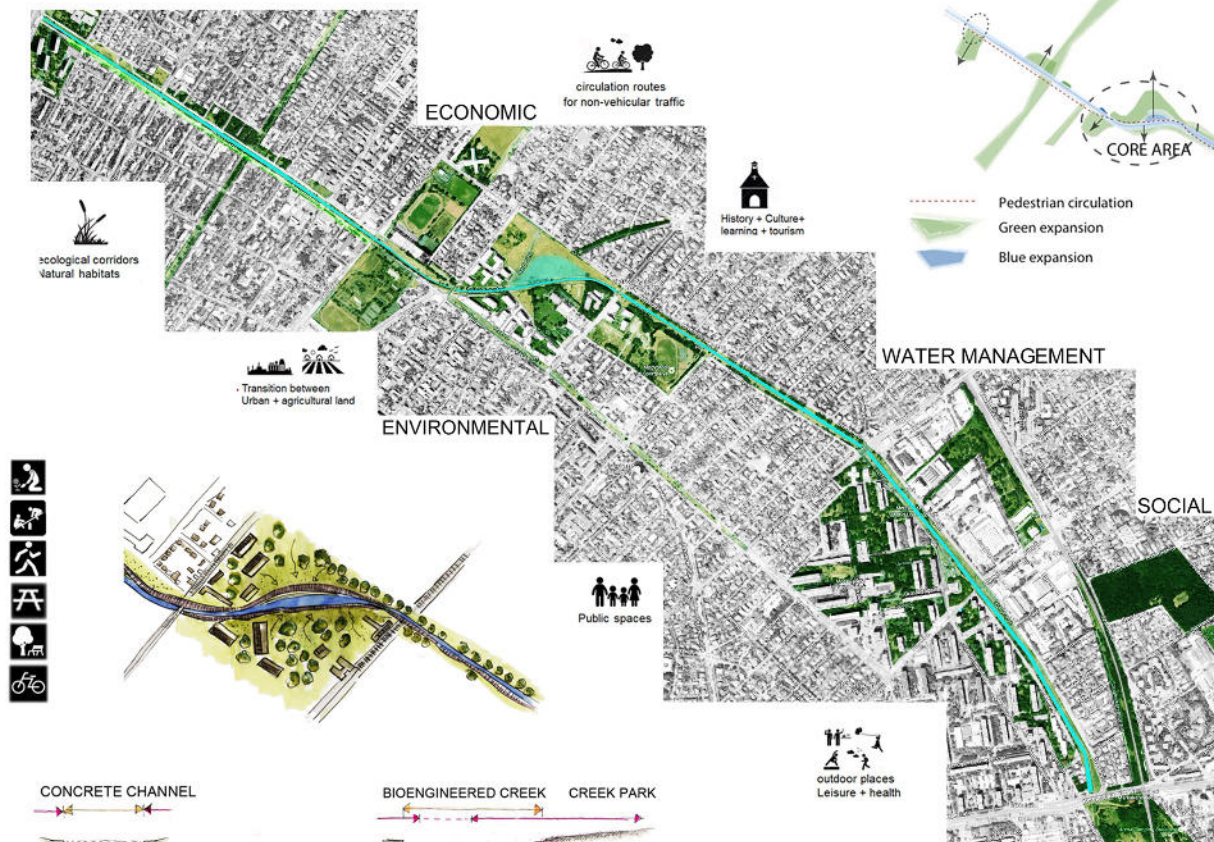

Pedestrian circulation
 Green expansion
 Blue expansion

CORE AREA

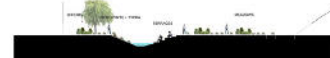

PROPOSAL CREEK SECTION 1



PROPOSAL CREEK SECTION 2



PROPOSAL CREEK SECTION 3



CONCRETE CHANNEL



BIOENGINEERED CREEK CREEK PARK



CREEK
 PRESENT
 SITUATION



PROPOSAL
 BLUE
 EXPANSION



RAKOS CREEK INTO BLUE + GREEN WAY

IMPLUVIUM urban prototype

rainwater catchment system

Impluvium will provide a water feature on the public space
The piece will be able to collect water and will gather people
together in an environment as pleasant and climatically comfortable.
Rainwater flows over a conical canopy creating an unique water-based
atmosphere.



collecting stormwater



OPEN SPACE DESIGN BUDA CAMPUS ENTRANCE BUDAPEST

Project goal: A new entrance area for the Buda Campus at Corvinus University of Budapest, from Villányi Street in front of Building 'K' with replacement of the present parking lot.

Level of the design: from conceptual level to construction drawings.

The design goal for the campus open space is to create a pleasant environment of open spaces and facilities that will support the academic and student life of the campus by linking the entrance and main buildings with the most significant feature of the Faculty – The Arboretum. In addition, the project transforms the parking lot into an open square. The permeable pavement uses a green color range integrating the planting design and orchards into the pattern square. The furniture system emerges from the pavement integrating fix benches, information boarding panels and lighting elements. In addition the project proposes movable chairs which enlarge the possibilities of different activities: students truly decide where they want to sit in the square.

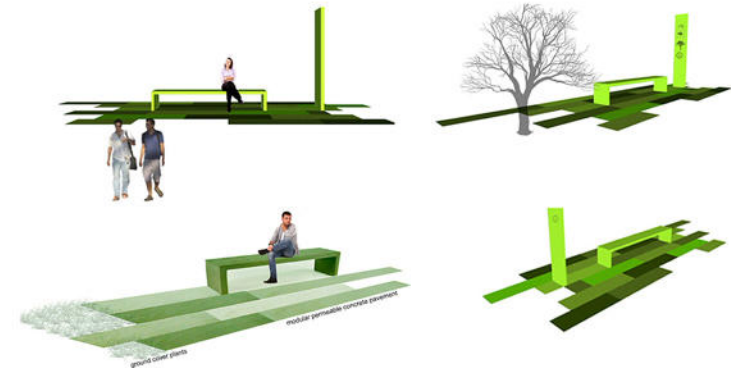
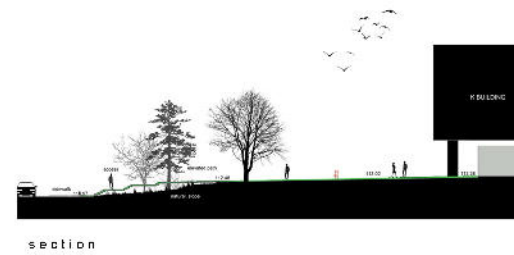
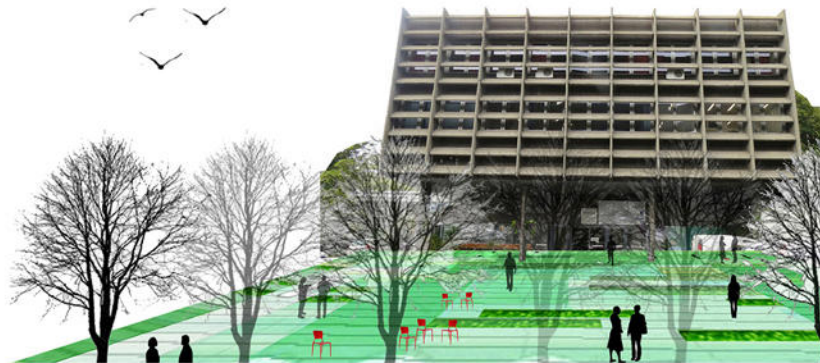
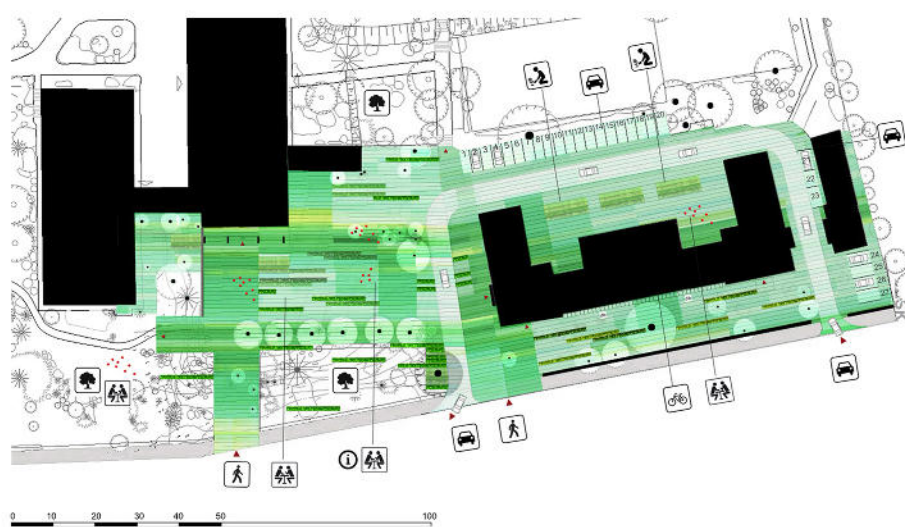

system: pavement + bench + signage graphic+light ① ②



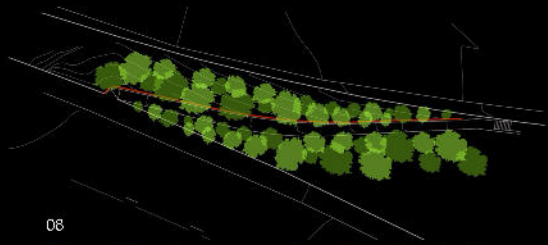

08

diluted landscapes, drawing the limits

Inspired by the unique and varied vegetation that grows wild and naturally through the path and inspired by the international movement of architecture and decorative arts from Art Nouveau at the turn of the 20th century, the intervention situated in the pedestrian path through woodland, proposes a dialogue with the natural existing environment, through an element conceived by sinuous lines of natural forms that integrates furniture design, landscape and art. This natural wooden element, drawn in the landscape, dilutes the limits between the natural and the urban context.

The project *Diluted landscapes, drawing the limits*, is the realization of an inverse exercise of intervention in urban and natural spaces that explores new aspects to redefine those borders. The piece creates a new landscape, drawn with a wooden element that complements the existing forest—a forest to be walked through. This transformation from the natural landscape into a drawn landscape generates a mixed environment of contact and transition between both surroundings, modifying the nature, altering the relationship between constructed and unconstructed context and diluting and extending the limits of the pathway. At the same time the piece functions as a skin of an urban observatory from which it is possible to contemplate the city through the vegetation.

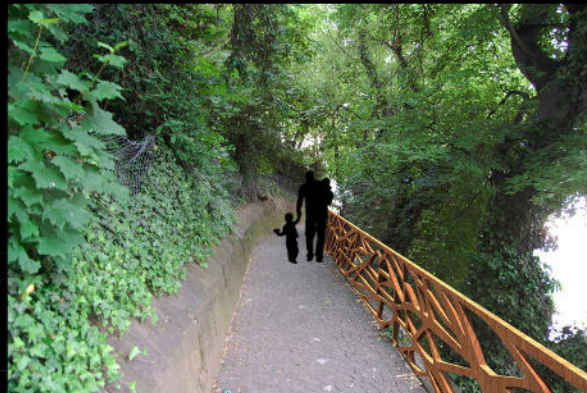



08 memorial
WATER POEMS

Orange County Memorial Crime Victims'
William R. Mason Regional Park
Orange County, California, USA
(competition. Finalist)



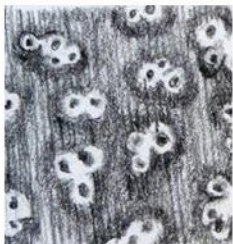
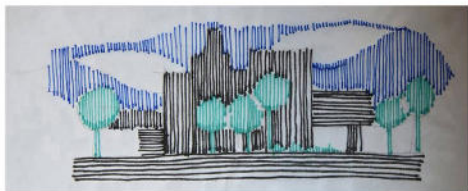
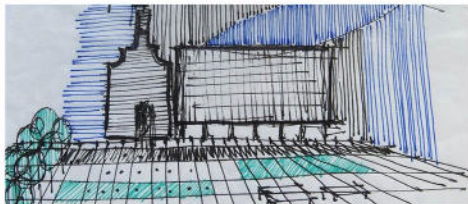
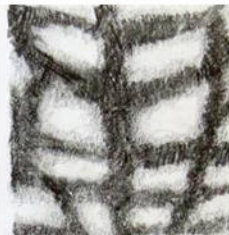

LEAF PATTERNS



BUD AND BRANCHLET STUDIES



BOTANICAL ILLUSTRATION:

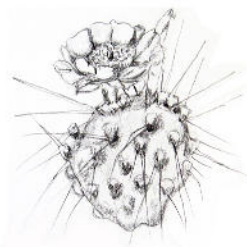

SKETCH BOOK

landscape graphics

paper and light
study
representation
exploring
topography
space and
form
through the
cutting,
folding,
and weaving
of paper

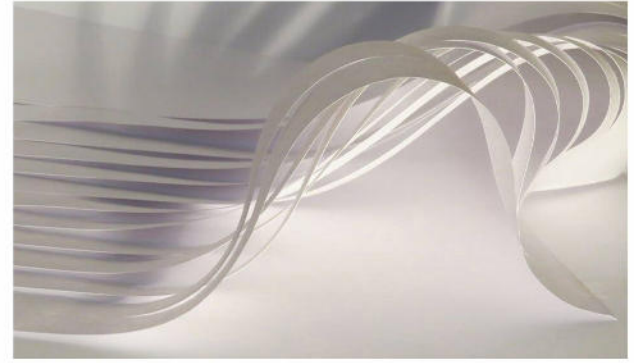
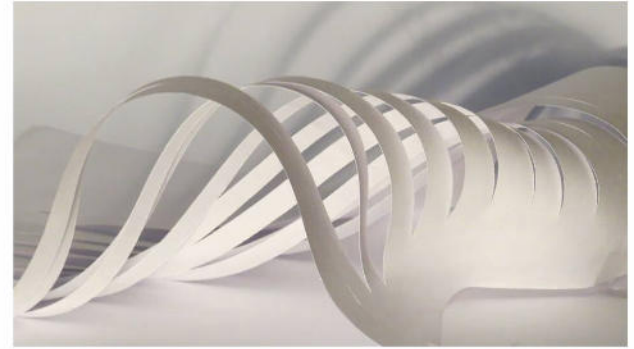

lecture at ig architektur.Vienna



IVÁN JUÁREZ: SENSORY LANDSCAPES

Dienstag, 24. Juni 2014 | 19 Uhr
ig Architektur, Dampendorferstrasse 63B, 1080 Wien

Begrüßung: Luis Alfonso de Alba, Rector de la UAM
Einführung: Martina Baril-Schneider, Architektin, CPTA, Austria
Vortrag in englischer Sprache: Iván Juárez, Architekt

Iván Juárez arbeitet interdisziplinär zwischen Architektur, Landschaftsarchitektur, Design und Installation. Seine Projekte beziehen sich gleichermaßen auf Raum und Gesellschaft wie Kunst & Funktion. Das von ihm gegründete x. studio forrest und agiert in zeitgenössischen Ausdrucksformen und manifestiert internationale Ausstellungen, Vorträge und Publikationen. Iván Juárez hat mehrere internationale Auszeichnungen erhalten - u. a. Prize Design Vanguard, T&N World Young Architects of the Year / Architectural Record, Architectural League Prize. Der mexikanische Architekt unterrichtet an der Universität von San Luis Potosí und der La Salle Universität in Mexiko.

Iván Juárez wird im Juni und Juli 2014 als Artist-in-Residence in Wien zu Gast sein. ORTE freut sich, sein spannendes wie poetisches Œuvre der österreichischen Öffentlichkeit vorzustellen.

Ankündigung bei Götter & Engel.

lecture
LA HIPPOCAMPUS Land Art summer course

lecture at FUGA Budapest

FUGA Budapesti Építészeti Központ
Budapest Center of Architecture
Érzékeny tájak . Sensory Landscapes

teaching: guest lecturer

MLA. CORVINUS UNIVERSITY OF BUDAPEST. FACULTY OF LANDSCAPE ARCHITECTURE

sensory landscapes. elective course
Gellert Hill + Autumn fall foliage

The course connects concepts, traces and narratives that identify the natural and urban landscape of Gellert Hill in Budapest through walking experiences.

Students conceptualized walking routes and identified situations and potential specific sites to propose their projects.

Students have learned the site specific installation's production process and get familiarized with all its phases.

Course Unit Content:

- Theoretical lectures: basics of environmental art, the creative process, genius loci and case studies
- Gellert Hill: Site approach and walking as a sensory experience
- Design studio: Development of specific site intervention projects applying concepts related to sensory landscapes
- Presentation: visual and three dimensional models applying tactile and/or sensory mediums.

MLA STUDENTS

1. Daria ERMAKOVA VLAGIMIROVNA
2. Derek ROBINSON
3. Jie ZHAO
4. Willian Moisés GONZÁLES ARMAS
5. Joana DIMITROVSKA j
6. Orkhan AFANDIYEV
7. Song Yimeng YIMENG
8. Mostafa Kamel BENHADDIA
9. Afaf HAMZAQUI
10. Malgorzata Stryjek g



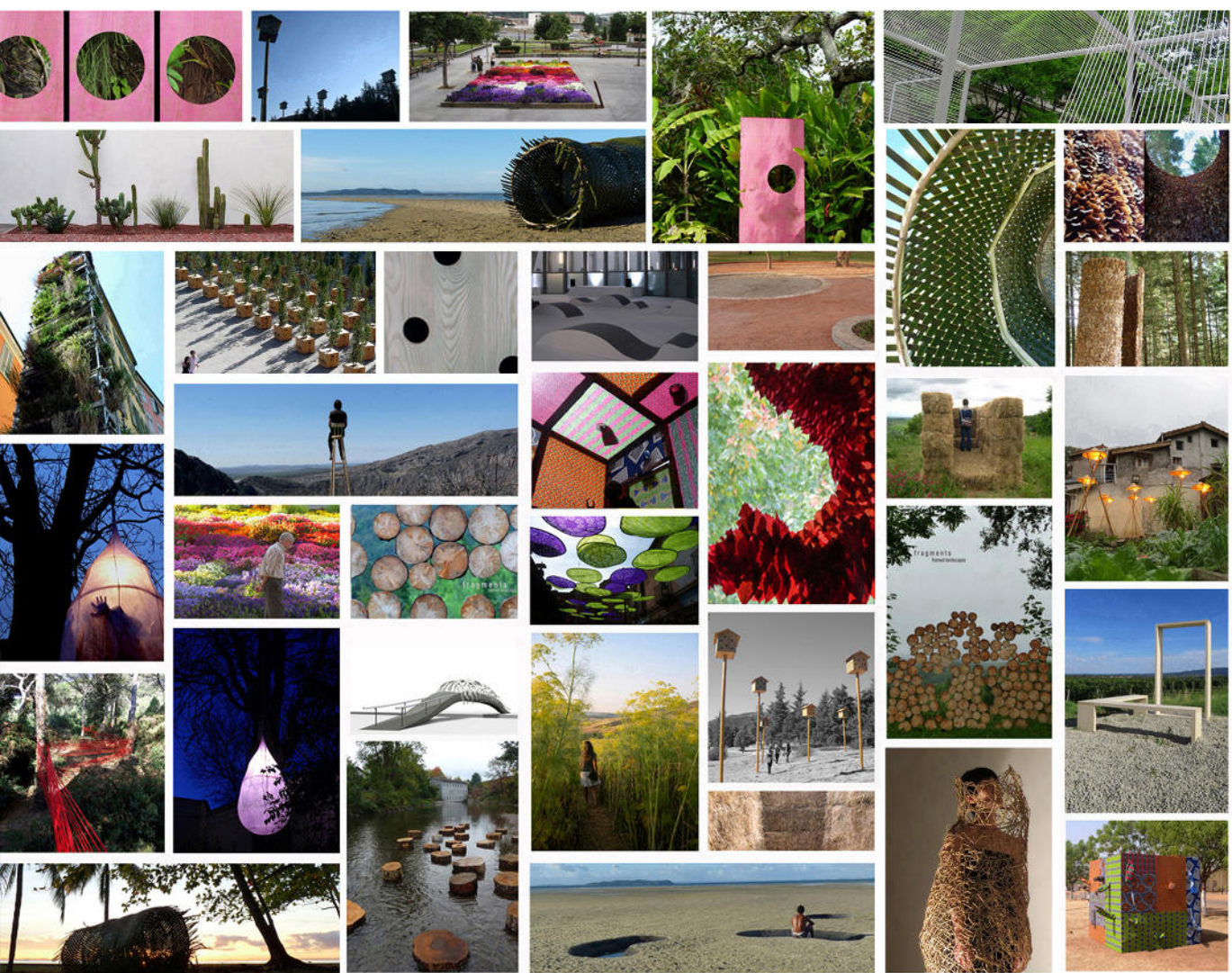

```
previous works
practice
```

site specific interventions

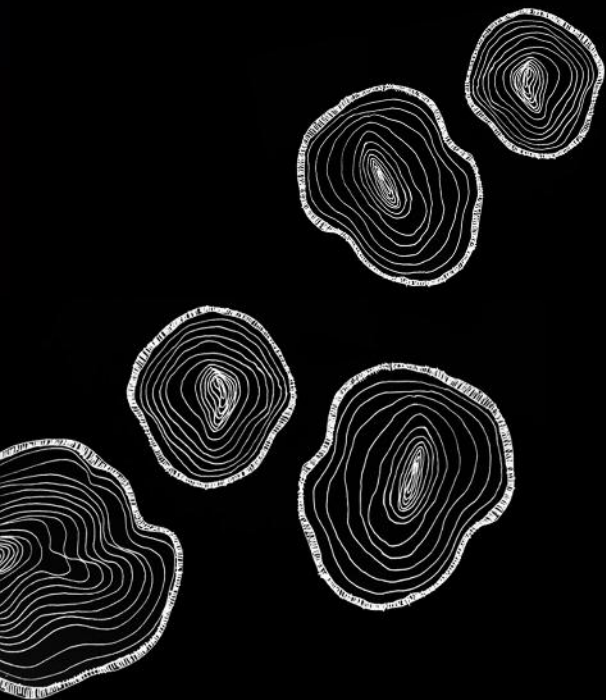

ivan juarez . mla . 2014-2016